

FORM NO 1.

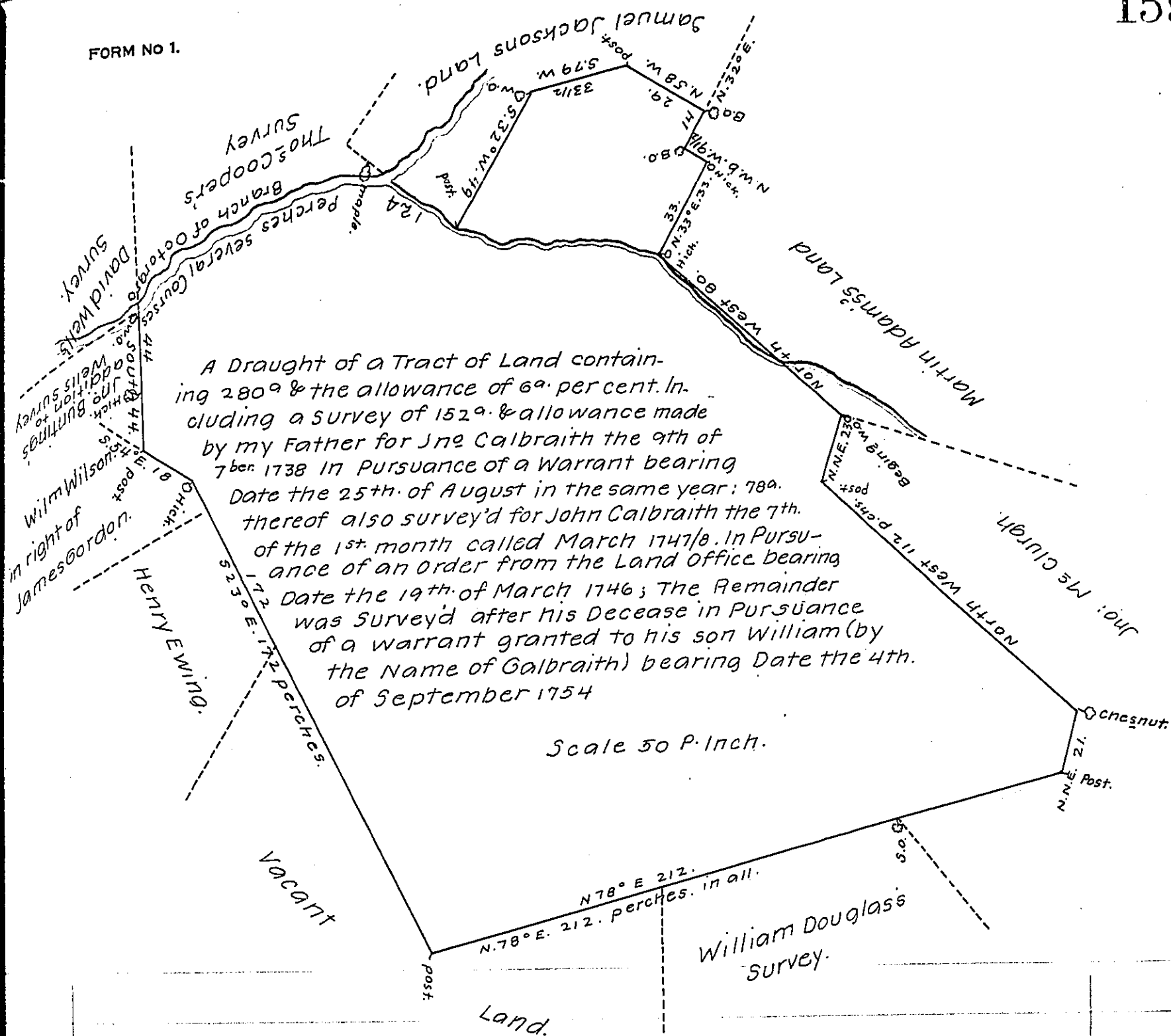

The Tract of Land above Described Lays on the Big Run, a Branch of Octoraro Creek, in Oxford Township Chester. Co^{ty} Containing three Tracts added in one Draught, according to the description above, Beginning for the whole at a white oak corner of Martin Adams his Survey & Running by a Line of the same North west 80^{os}. &c^a as above. Certify'd By

Geo: Churchman D.S.

IN TESTIMONY that the above is a copy of the original remaining on file in the Department of Internal Affairs of Pennsylvania, made conformably to an Act of Assembly approved the 16th day of February, 1833, I have hereunto set my Hand and caused the Seal of said Department to be affixed at Harrisburg, this seventh day of October 1907.

Henry Houck
Secretary of Internal Affairs.